

# SK10 series fuel dispenser

## Features:



- Practical configurations:**  
 Single hose, wide range of configuration  
 Available for gasoline and diesel
- Highly trustable and accurate SANKI flow meter**  
 4 piston design, inlet up and out down design to ensure clean of flow meter  
 Reduce fuel loss by highly stable and accurate flow meter
- Build to harshest environment**  
 Frame and panel is material with cold plated steel, with very strong construction  
 Electronic designed to fit for ultra high and ultra low environment -40℃~+50℃  
 Motor is designed with wide range of voltage working
- Easy for maintenance**  
 Global accessible spare parts for maintenance  
 Modular designed electronic and hydraulic easy to replace parts.



ISO 9001



OIML



CNEX



ISO14001



PEI

## Technical parameters :

Accuracy for the unit	±0.25%
Standard flow rate	45L/min
Ambient temperature	-25℃~+55℃; -40℃~+50℃
Relative humidity	20% - 95%
Unit noise rate	< 70dB (A);
Inlet vacuum rate for suction pump	≥54kPa
Communication	With RS 485 port, or current loop
Power supply	AC 220V( -15%~+10%); (50/60±1)Hz ; AC 380V( -15%~+10%); (50/60±1)Hz
Digit of sale	7digits (Decimal points can be adjusted)
Digit of volume	6digits (Decimal points can be adjusted)
Digit of unit price	5digits (Decimal points can be adjusted)
Totalizer of sale	0~42949672.95
Totalizer of volume	0~42949672.95

## Optional configuration :

Printer, IC card, ID card, communication for FMS, break away, swivel, emergency stop, color screen, etc.

## Model Range:

Model	Pump Unit	Nozzle	Product	Display	Packing Size(mm)	Gross Weight(Kg)
SK10ZF111B	Suction pump	1	1	2	768*546*1570	130
SK10QF111B	Submersible pump	1	1	2	768*546*1570	104

Beijing Sanki Petroleum Technology Co., Ltd.

Add:19#, 6th Boxing Road, Economic-Technological Development Area, Beijing, P.R. China 100176

Tel: 0086-10-52310740 E-mail: business@sankichina.com

# SK15 series fuel dispenser

## Features:

- **Economic Pump/dispenser ranges :**  
1-2 hose, customized design for different customer and different demands  
Optional for pump and dispenser, available for gasoline and diesel
- **Highly trustable and accurate SANKI flow meter**  
4 piston design, inlet up and out down design to ensure clean of flow meter  
Reduce fuel loss by highly stable and accurate flow meter
- **Build to harshest environment**  
Frame and panel is material with cold plated steel, with very strong construction  
Electronic designed to fit for ultra high and ultra low environment -40 C ~ +50 C  
Motor is designed with wide range of voltage working
- **Easy for maintenance**  
Global accessible spare parts for maintenance  
Modular designed electronic and hydraulic easy to replace parts

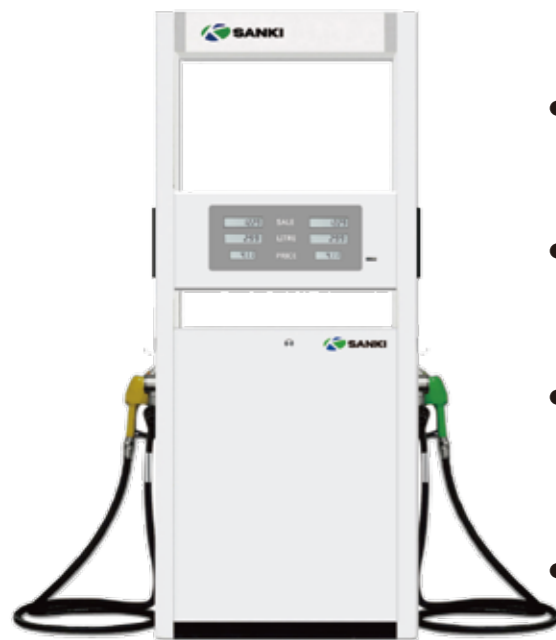

ISO 9001



OIML



CNEX



ISO 14001



PEI

## ● Technical parameters :

Accuracy for the unit	±0.25%
Standard flow rate	45L/min
Ambient temperature	-25 C ~ +55 C ; -40 C ~ +50 C
Relative humidity	20% - 95%
Unit noise rate	< 70dB (A);
Inlet vacuum rate for suction pump	≥54kPa
Communication	With RS 485 port, or current loop
Power supply	AC 220V( -15%~+10%); (50/60±1)Hz ; AC 380V( -15%~+10%); (50/60±1)Hz
Digit of sale	7digits (Decimal points can be adjusted)
Digit of volume	6digits (Decimal points can be adjusted)
Digit of unit price	5digits (Decimal points can be adjusted)
Totalizer of sale	0~42949672.95
Totalizer of volume	0~42949672.95

## ● Optional configuration :

Printer , ID card , communication for FMS , break away, swivel, emergency stop, LED light, etc.

## ● Model Range :

Model	Pump Unit	Nozzle	Product	Display	Packing Size(mm)	Gross Weight(Kg)
SK15ZF111B	Suction pump	1	1	2	1080*490*2188	145
SK15ZF212B		2	1	4	1080*490*2188	160
SK15ZF222B		2	2	4	1080*490*2188	186

Beijing Sanki Petroleum Technology Co., Ltd.

Add:19#, 6th Boxing Road, Economic-Technological Development Area, Beijing, P.R. China 100176

Tel: 0086-10-52310740 E-mail: business@sankichina.com

# SK52 series fuel dispenser



## Features:

- Flexible Pump/dispenser ranges**  
 1-2 hose, wide range of configuration  
 Optional for pump and dispenser, 45 to 80 lpm.  
 Customized design for different customer and different demands  
 Available for gasoline and diesel
- Highly trustable and accurate SANKI flow meter**  
 4 piston design, inlet up and out down design to ensure clean of flow meter  
 Reduce fuel loss by highly stable and accurate flow meter
- Build to harshest environment**  
 Frame and panel is material with cold plated steel, with very strong construction  
 Electronic designed to fit for ultra high and ultra low environment -40°C ~ +50°C  
 Motor is designed with wide range of voltage working
- Easy for maintenance**  
 Global accessible spare parts for maintenance  
 Modular designed electronic and hydraulic easy to replace parts



ISO 9001



OIML



CNEX



ISO 14001



PEI

## Technical parameters :

Accuracy for the unit	±0.25%
Flow rate	45~80L/min
Ambient temperature	-25°C ~ +55°C ; -40°C ~ +50°C
Relative humidity	20% - 95%
Unit noise rate	< 70dB (A);
Inlet vacuum rate for suction pump	≥54kPa
Communication	With RS 485 port, or current loop
Power supply	AC 220V( -15%~+10%);(50/60±1)Hz ; AC 380V( -15%~+10%);(50/60±1)Hz
Digit of sale	7digits (Decimal points can be adjusted )
Digit of volume	6digits (Decimal points can be adjusted )
Digit of unit price	5digits (Decimal points can be adjusted )
Totalizer of sale	0~42949672.95
Totalizer of volume	0~42949672.95

## Optional configuration :

Printer, IC card, ID card, communication for FMS, vapor recovery, break away, swivel, emergency stop, LED light, etc.

## Model Range :

Model	Pump Unit	Nozzle	Product	Flow Rate	Display	Package Size(mm)	Gross Weight(Kg)
SK52Z/GF111B	Suction pump	1	1	45/60/80	2	1080*490*2188	230/245
SK52Z/GF212B		2	1	45/60/80	2	1080*490*2188	265/280
SK52Z/GF222B		2	2	45/60/80	2	1080*490*2188	293/308
SK52QF111B	Submersible pump	1	1	45/60/80	2	1080*490*2188	200
SK52QF212B		2	1	45/60/80	2	1080*490*2188	223
SK52QF222B		2	2	45/60/80	2	1080*490*2188	230

Beijing Sanki Petroleum Technology Co., Ltd.

Add: 19#, 6th Boxing Road, Economic-Technological Development Area, Beijing, P.R. China 100176

Tel: 0086-10-52310740 E-mail: business@sankichina.com

# SK56 series fuel dispenser

## Features:

- Alternative fuel supply to increase customer loyalty**  
 4-8 hose, come in a range of fuel option  
 Optional for pump and dispenser, available for gasoline and diesel
- Highly trustable and accurate SANKI flow meter**  
 4 piston design, inlet up and out down design to ensure clean of flow meter  
 Reduce fuel loss by highly stable and accurate flow meter
- Build to harshest environment**  
 with very strong construction with good material  
 Electronic designed to fit for ultra high and ultra low environment -40°C~50°C  
 Motor is designed with wide range of voltage working
- Easy for maintenance**  
 Global accessible spare parts for maintenance  
 Modular designed electronic and hydraulic easy to replace parts



ISO 9001



OIML



CNEX



ISO14001



PEI

## Technical parameters :

Accuracy for the unit	±0.25%
Standard flow rate	45L/min
Ambient temperature	-25℃~+55℃; -40℃~+50℃
Relative humidity	20% - 95%
Unit noise rate	< 70dB (A);
Inlet vacuum rate for suction pump	≥54kPa
Communication	With RS 485 port, or current loop AC 220V( -15%~+10%); (50/60±1)Hz;
Power supply	AC 380V( -15%~+10%); (50/60±1)Hz
Digit of sale	7digits (decimal points can be adjusted)
Digit of volume	6digits (Decimal points can be adjusted)
Digit of unit price	5digits (Decimal points can be adjusted)
Totalizer of sale	0~42949672.95
Totalizer of volume	0~42949672.95

## Optional configuration :

Printer, IC card, ID card, communication for FMS, vapor recovery, break away, swivel, emergency stop, etc.

## Model Range :

Model	Pump Unit	Nozzle	Product	Display	Package Size(mm)	Gross Weight(Kg)
SK56GF422B	Suction pump	4	2	2	1318*820*2480	397
SK56GF632B		6	3	2	1318*820*2480	427
SK56GF842B		8	4	2	1360*820*2480	600
SK56QF422B	Submersible pump	4	2	2	1318*820*2480	315
SK56QF632B		6	3	2	1318*820*2480	349
SK56QF842B		8	4	2	1360*820*2480	383

Beijing Sanki Petroleum Technology Co., Ltd.

Add:19#, 6th Boxing Road, Economic-Technological Development Area, Beijing, P.R. China 100176

Tel: 0086-10-52310740 E-mail: business@sankichina.com

# SK65 series fuel dispenser

## Features:



- Alternative fuel supply to increase customer loyalty**  
 4-8 hose, come in a range of fuel option  
 Optional for pump and dispenser, available for gasoline and diesel
- Highly trustable and accurate SANKI flow meter**  
 4 piston design, inlet up and out down design to ensure clean of flow meter  
 Reduce fuel loss by highly stable and accurate flow meter
- Build to harshest environment**  
 With very strong construction with good material  
 Electronic designed to fit for ultra high and ultra low environment -40°C~+50°C  
 Motor is designed with wide range of voltage working
- Easy for maintenance**  
 Global accessible spare parts for maintenance  
 Modular designed electronic and hydraulic easy to replace parts



ISO 9001



OIML



CNEX



ISO14001



PEI

## Technical parameters :

Accuracy for the unit	±0.25%
Standard flow rate	45L/min
Ambient temperature	-25 °C ~ +55 °C ; -40 °C ~ +50 °C
Relative humidity	20% - 95%
Unit noise rate	< 70dB (A);
Inlet vacuum rate for suction pump	≥54kPa
Communication	With RS 485 port, or current loop
Power supply	AC 220V( -15%~+10%); (50/60±1)Hz; AC 380V( -15%~+10%); (50/60±1)Hz
Digit of sale	7digits (decimal points can be adjusted)
Digit of volume	6digits (decimal points can be adjusted )
Digit of unit price	5digits (decimal points can be adjusted)
Totalizer of sale	0~42949672.95
Totalizer of volume	0~42949672.95

## Optional configuration :

Printer, IC card, ID card, communication for FMS, break away, swivel, emergency stop,etc.

## Model Range :

Model	Pump Unit	Nozzle	Product	Display	Package Size(mm)	Gross Weight(Kg)
SK65Z/GF422B	Suction pump	4	2	2	1180*740*2115	345/375
SK65Z/GF632B		6	3	2	1633*740*2115	444/489
SK65Z/GF842B		8	4	2	2087*740*2115	550/610
SK65QF422B	Submersible pump	4	2	2	1180*740*2115	275
SK65QF632		6	3	2	1633*740*2115	340
SK65QF842B		8	4	2	2087*740*2115	410

Beijing Sanki Petroleum Technology Co., Ltd.

Add:19#, 6th Boxing Road, Economic-Technological Development Area, Beijing, P.R. China 100176

Tel: 0086-10-52310740 E-mail: business@sankichina.com

# SK66 series fuel dispenser

## Features:



- Alternative fuel supply to increase customer loyalty**  
 4-8 hose, come in a range of fuel option  
 Optional for pump and dispenser, available for gasoline and diesel
- Highly trustable and accurate SANKI flow meter**  
 4 piston design, inlet up and out down design to ensure clean of flow meter  
 Reduce fuel loss by highly stable and accurate flow meter
- Build to harshest environment**  
 With very strong construction with good material  
 Electronic designed to fit for ultra high and ultra low environment -40°C~+50°C  
 Motor is designed with wide range of voltage working
- Easy for maintenance**  
 Global accessible spare parts for maintenance  
 Modular designed electronic and hydraulic easy to replace parts



ISO 9001



OIML



CNEX



ISO14001



PEI

## Technical parameters :

Accuracy for the unit	±0.25%
Standard flow rate	45L/min
Ambient temperature	-25 °C ~ +55 °C ; -40 °C ~ +50 °C
Relative humidity	20% - 95%
Unit noise rate	< 70dB (A);
Inlet vacuum rate for suction pump	≥54kPa
Communication	With RS 485 port, or current loop
Power supply	AC 220V( -15%~+10%); (50/60±1)Hz; AC 380V( -15%~+10%); (50/60±1)Hz
Digit of sale	7digits (Decimal points can be adjusted )
Digit of volume	6digits (Decimal points can be adjusted )
Digit of unit price	5digits (Decimal points can be adjusted )
Totalizer of sale	0~42949672.95
Totalizer of volume	0~42949672.95

## Optional configuration :

Printer, IC card, ID card, communication for FMS, break away, swivel, emergency stop,etc.

## Model Range :

Model	Pump Unit	Nozzle	Product	Display	Package Size(mm)	Gross Weight(Kg)
SK66Z/GF422B	Suction pump	4	2	2	1625*755*2310	366/396
SK66Z/GF632B		6	3	2	1885*755*2310	395/440
SK66QF422B	Submersible pump	4	2	2	1625*755*2310	316
SK66QF632B		6	3	2	1885*755*2310	330
SK66QF842B		8	4	2	2195*755*2310	380

Beijing Sanki Petroleum Technology Co., Ltd.

Add:19#, 6th Boxing Road, Economic-Technological Development Area, Beijing, P.R. China 100176

Tel: 0086-10-52310740 E-mail: business@sankichina.com

# Hi-flow fuel dispenser



## Features:

- **Alternative fuel supply to increase customer loyalty.**  
1hose, come in a range of fuel option.  
Optional for pump and dispenser, 100 to 180 lpm.  
Available for gasoline and diesel.
- **Highly trustable and accurate SANKI flow meter**  
4 piston design, inlet up and out down design to ensure clean of flow meter  
Reduce fuel loss by highly stable and accurate flow meter.
- **Build to harshest environment**  
With very strong construction with good material  
Electronic designed to fit for ultra low environment -40°C ~ +50°C  
Motor is designed with wide range of voltage working
- **Easy for maintenance**  
Global accessible spare parts for maintenance.  
Modular designed electronic and hydraulic easy to replace parts.



ISO 9001



OIML



CNEX



ISO14001



PEI

## ● Technical parameters :

Accuracy for the unit	±0.25%
Flow rate	100~120L/min; 120~150L/min; 150~180L/min;
Ambient temperature	-25℃~+55℃; -40℃~+50℃
Relative humidity	20% - 95%
Unit noise rate	< 70dB (A);
Inlet vacuum rate for suction pump	≥54kPa
Communication	With RS 485 port, or current loop
Power supply	AC 220V( -15%~+10%); (50/60±1)Hz; AC 380V( -15%~+10%); (50/60±1)Hz
Digit of sale	7digits (Decimal points can be adjusted )
Digit of volume	6digits (Decimal points can be adjusted )
Digit of unit price	5digits (Decimal points can be adjusted )
Totalizer of sale	0~42949672.95
Totalizer of volume	0~42949672.95

## ● Optional configuration :

Printer, IC card, ID card, communication for FMS, break away, emergency stop, LED light,etc.

## ● Model Range :

Model	Pump Unit	Nozzle	Product	Flow Rate	Package Size(mm)	Gross Weight(Kg)
SK52G/ZF111B(HD)	suction pump	1	1	100~120	1080*490*2188	245
SK52QF111B(HD)	submersible pump	1	1	100~120	1080*490*2188	200
SK52GM111B(HD)	suction pump	1	1	120~150	1080*490*2188	245
SK52QM111B(HD)	submersible pump	1	1	150~180	1080*490*2188	200

Beijing Sanki Petroleum Technology Co., Ltd.

Add:19#, 6th Boxing Road, Economic-Technological Development Area, Beijing, P.R. China 100176

Tel: 0086-10-52310740 E-mail: business@sankichina.com

# Heavy Duty Fuel Dispenser



## Features:

- Specially applied to refueling for train and large ship
- Flow meter performs well, with  $\pm 0.25\%$  accuracy
- Electrically droved valve works steady in dirty liquid
- Double stage filter system keeps the fuel clean and prolongs the life time for flow meter
- Card authorization for work staff
- ARM electronic system, display for density, kilogram, liter.
- For diesel only.



ISO 9001



OIML



CNEX



ISO14001



PEI

## ● Technical parameters :

Accuracy for the unit	$\pm 0.25\%$
Flow rate	300~500L/min; 800~1000L/min;
Ambient temperature	-25℃~+55℃; -40℃~+50℃
Relative humidity	20% - 95%
Unit noise rate	< 70dB (A);
Inlet vacuum rate for suction pump	$\geq 54\text{kPa}$
Communication	With RS 485 port, or current loop
Power supply	AC 220V( -15%~+10%); (50/60 $\pm 1$ )Hz; AC 380V( -15%~+10%); (50/60 $\pm 1$ )Hz
Digit of sale	7digits (Decimal points can be adjusted )
Digit of volume	6digits (Decimal points can be adjusted )
Digit of unit price	5digits (Decimal points can be adjusted )
Totalizer of sale	0~42949672.95
Totalizer of volume	0~42949672.95

## ● Optional configuration :

Pump, motor, card reader payment, mass flow meter, heater for ultra low temperature, communication for FMS standard electronics interface to POS and automation fuel management system

## ● Model Range :

Model	Nozzle	Product	Flow Rate	Packing Size(mm)
SK56HY111B	1	1	300~500	1490*1018*605
	1	1	800~1000	1790*1250*705

Beijing Sanki Petroleum Technology Co., Ltd.

Add:19#, 6th Boxing Road, Economic-Technological Development Area, Beijing, P.R. China 100176

Tel: 0086-10-52310740 E-mail: business@sankichina.com



# Mobile Fuel Dispenser



## Features:

- It is installed on tank-truck to do mobile fueling service.
- It can also realize refueling service for the equipment which can't move in some places, especially like in the field, mine, and construction site etc.
- Compact design for convenient operation
- Two optionals for pump: internal or external installed.



ISO 9001



OIML



CNEX



ISO14001

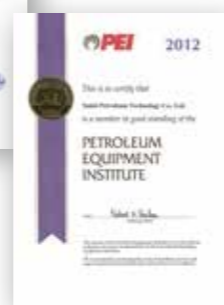

PEI

## ● Technical parameters :

Accuracy for the unit	±0.25%
Flow rate	50L/min, 60~80L/min, 100~150L/min, 180~240L/min
Ambient temperature	- 40 ℃ to +50 ℃
Relative humidity	20% - 95%
Communication	With RS 485 port, or current loop
Power supply	DC 12V /24V
Digit of sale	0.00~99999.99
Digit of volume	0.00~9999.99
Digit of unit price	0.00~999.99
Totalizer of sale	0~42949672.95
Totalizer of volume	0~42949672.95

## ● Optional configuration :

ID card, communication for FMS, break away, etc.

## ● Model Range :

Model	Pump Unit	Nozzle	Product	Flow Rate	Package Size(mm)
SK22QF111A	Internal pump	1	1	50	650*515*662
SK22QF111A	external pump	1	1	60-80	650*515*662
SK22QM111A		1	1	100-150	650*515*662
SK22QM111A		1	1	180-240	650*515*662

Beijing Sanki Petroleum Technology Co., Ltd.

Add:19#, 6th Boxing Road, Economic-Technological Development Area, Beijing, P.R. China 100176

Tel: 0086-10-52310740 E-mail: business@sankichina.com

# CONTAINERIZED TANK MOBILE FUELING STATION

Sanki supply customized mobile fuel station depending on your application and required flow rate.

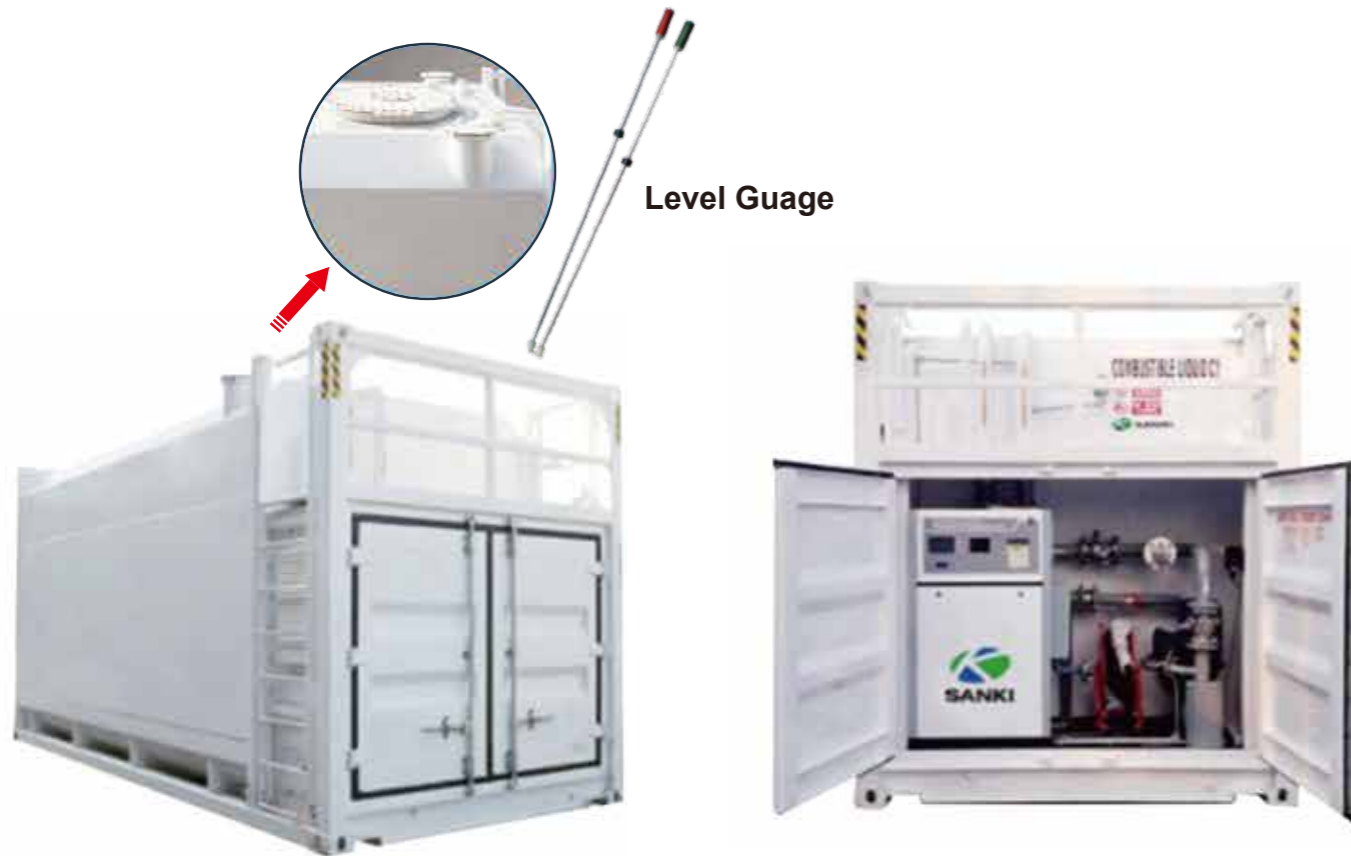

Level Gauge

## Features:

**Bounded tank** is for leakage protection.

**Color screen display**-----the real-time display for oil height, water height, and temp.

**Ratchet hose reel**----- by which the pipe can be stretched to 10 meters.

**Fuel delivery pump**-----optional fuel delivery pump and delivery pipe.

**Tank level gauge**-----detect oil level and water level, the temperature and check leakage.

**Continuous welding connection** of tank and container.

**The manhole** at top of the tank and the ladder inside is easy for operation.

## Container Tank Application:

- Small Fleet Refueling
- Home Base Fleet Refueling
- Home Base Refueling
- General Purpose
- Industrial
- Mining
- Tank trailer unloading
- Lubricant and Waste Oil fueling

## Refueling dispenser

### Features:

5 " colorful screen for optional-----Display: fuel height, water height, temperature

High performance for electric parts

Works well in harsh condition like extremely cold, hot, humid and sand-stormy environment.

Flow rate contains: 50L/min, 80L/min, 100L/min

Certification: ATEX, IEC



## Main parts of the piping system of the tank:

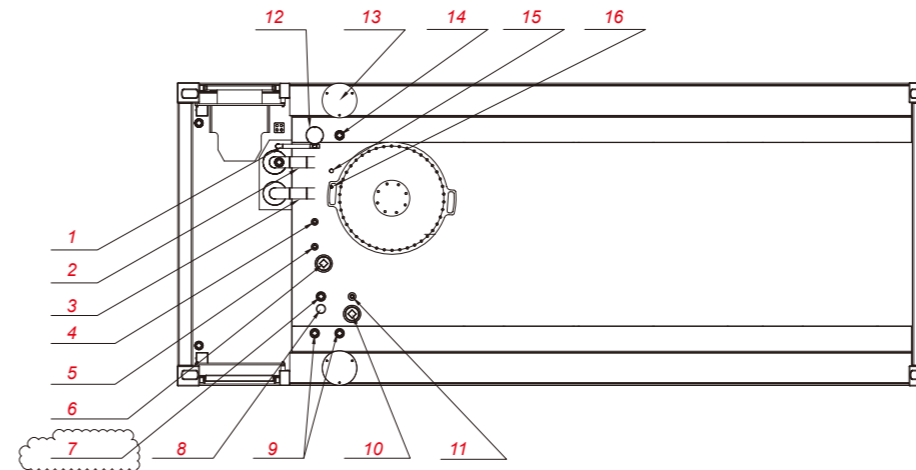

- 1)1 " oil return pipe
- 2)3 " Sucking pipe
- 3) 3 " Oil charging pipe system
- 4)1 " Standby return pipe
- 5) 1 " Coupling
- 6)4 " Standby sucking pipe
- 7) 2 " Interbeded leak pipe 3 " vent valve
- 8)2 " Garder pipe
- 9)3 " coupling
- 10)4 " coupling
- 11)1-1/4 " coupling
- 12)3 " vent valve
- 13)8 " Interbeded vent valve
- 14)2 " coupling
- 15)3/4 " coupling
- 16)1/4 " coupling

## Technical specification of the container tank:

Model	Tank Volume (L )	Length (mm )	Width (mm )	Weight (empty)	Height (mm )
20 feet container	30,000	60588	2438	8000kg	2896
40 feet container	66,000	12192	2438	15000kg	2896
Specification			Function		
Power supply	380V		Auto tank gauge		
Flow rate(refueling)	80~500 lit/min		Overfill & low production protection		
Nozzle & Hose(refueling)	1 inch,10 meters L		Leakage detection		
Flow rate(unloading)	500 lit/min E		Earth connection detection		
Quick coupling(unloading)	3 inch Hos		Hose reel		
Motor power (refueling)	2.2 to 5.5kw		Micro printer		
Motor power(unloading)	5.5kw		Automatic stop when overflow and no-fuel refueling		
Certifications	UL 142; CS safety				

Beijing Sanki Petroleum Technology Co., Ltd.

Add:19#, 6th Boxing Road, Economic-Technological Development Area, Beijing, P.R. China 100176

Tel: 0086-10-52310740 E-mail: business@sankichina.com

## SK series Automatic Tyre Inflator



### Features :

- Multi-function for your choice like tire inflation, dust removal, adding water or glass cleaner
- Convenient payment---coin operation
- LCD display
- Automatic tyre inflation with tyre pressure testing
- Works well in rigid environment.

### Technology specification of tyre inflation

Units of Measurement:	psi, kg/cm <sup>2</sup> (bar),kPa
Power Supply:	AC220V±10%,50Hz,600W
Operating Range:	0.3kg/cm <sup>2</sup> --7kg/cm <sup>2</sup>
Accuracy:	±0.07kgf/ cm <sup>2</sup>
Working Temperature:	-40 C--60 C
Environment Humidity:	0--90%
Working Pressure of Trachea:	14 kg/cm <sup>2</sup>
Burst Pressure of Trachea:	60kgf/ cm <sup>2</sup>
Tracheal Length:	10m
Noise:	≤ 45dB

### Technology specification of adding water or glass cleaner

PU input pipe	8X12mm (Diameter ratio) 1.0m (length)
PU output tube	8X12mm (Diameter ratio) 9.0m (length)
Working Pressure of Trachea	8kg/cm <sup>2</sup>
Burst Pressure of Trachea	20kg/cm <sup>2</sup>
Accuracy	±2%
Tracheal Length	8m
Water tank capacity	50L
Working Temperature	-40 C --60 C

### Technology specification of absorbing dust

Power Supply:	1200W , 220V
Cooling Mode:	Cycle
Vacuum Suction:	2000mmH2O
Gas Flow:	53L/s
Noise:	≤62dB

### Model Range

Model	Function	Package Size(mm)	Gross Weight(kg)
SK-A/O	inflation	700*650*1550	95
SK-AW/O	inflation, adding water	700*650*1550	95
SK-AWC/M	inflation, adding water, dust removal, dust removal, coin operation	1450*590*1730	216
SK-ALC/M	inflation, adding glass cleaner, dust removal, dust removal, coin operation	1450*590*1730	216

Beijing Sanki Petroleum Technology Co., Ltd.

Add:19#, 6th Boxing Road, Economic-Technological Development Area, Beijing, P.R. China 100176

Tel: 0086-10-52310740 E-mail: business@sankichina.com

## SKE series Automatic Digital Tyre Inflator

The SKE series Freestanding Digital tyre inflator is designed for any automotive service facility; it enhances site image and provides safe, accurate and reliable tyre inflation for customers. It provide 3 type: indoor, outdoor(water proof)and with water supply for optional.

### Provide air/nitrogen inflation

#### Product features:

- 174PSI/12bar/1200kPa Output pressure
- Provide air/Nitrogen inflation
- Fit for almost any size automotive service facility
- Auto-Start Inflation
- Automatic zero drift adjustment
- Self-diagnostic & error reporting
- Cast base & extruded aluminium body with high quality powder coat finish
- Beeps" after finish inflation operation
- Suit for: Car, Light Truck, Bus



**SKE-012-OD**  
indoor



**SKE-012-OD-WP**  
outdoor



**SKE-012-OD-WP-WA**  
in/outdoor +water supply

### Technical specification:

Dimensions (Height*Width*Depth)	1260mm*360mm*360mm 49.6**14.2**14.2"
Net Weight	17.5kg/38.6lbs
Gross Weight	21kg/44.6lbs
Packing Size (Height*width*Depth)	200mm*1290mm*360mm 7.9**50.8**15.7"
Power Requirement	100-240Vac 50/60HZ
Power Consumption	23VA
Operating Temperature Range	-20℃/-4 ℉ to 70℃ /158 ℉
Max Inlet Air/ Nitrogen Supply	217PSI/ 15bar /1500kPa
Operating Range	5-174PSI/0.3-12bar/35-1200kPa
Accuracy	±1PSI/0.07bar / 7kPa
Resolution	1PSI/ 0.1bar /5kPa
Units of Measurement	PSI/ bar / kPa



**LCD Back light**

**High reliability  
(vandal resistant)  
Piezo switches.**

### Accessory:

Nos.\*10M/32.8ft standard hose with single clip-on open type chuck

### Operation Steps:

- Set final target pressure using the +and -buttons.The LCD screen will show the target pressure.
- Connect air hose to tire valve stem
- Push the "FILL" button once
- When unit "beeps" and the LCD screen flashes the target pressure, tire inflation is complete
- Immediately remove hose

Beijing Sanki Petroleum Technology Co., Ltd.

Add:19#, 6th Boxing Road, Economic-Technological Development Area, Beijing, P.R. China 100176

Tel: 0086-10-52310740 E-mail: business@sankichina.com

# SP300 Magnetostrictive Probe



## Features:

- Latest magnetostrictive technology and digital electronic technology
- Precise five sensors provide the accurate measure for product temperature reliable and environment Compatibility
- High quality non-corrosion 316 stainless steel ensure longer lifetime monitoring in most petroleum products. Easy to install and operate.
- Used for gasoline, diesel and other approved light oil liquids.
- Available length is from 1m to 4m.

Power supply	DC12V, 50mA	Maximum communication distance	500m
Precision	±0.5mm;	Communication	RS-485
Repeatability	±0.2mm	Intrinsic safety parameter	Power port: $U_i = 15V, I_i = 400mA, P_i = 1.2W, C_i = 4.85\mu F, L_i = 0;$
Resolution of product level	0.01mm		Signal port: $U_i = 7.14V, I_i = 147mA, P_i = 0.26W, C_i = 0, L_i = 0;$
Resolution of temperature	0.0625 C	Mark of explosion proof	Exia II AT4
Resolution of water level	0.01mm	Associated apparatus	Windbell GSB03 safety barrier
Temperature range	- 40 C ~ 60 C ;	Medium applicable	Gasoline, kerosene, diesel, light oil, heavy oil ,alcohol mixture,
Points of temperature measured	5	Communication address	6 digits, please see "Manufacturing Code " on nameplate of probe

## How to get the probe length?

The probe length means the length from the bottom to the top under the electronic part, please see the graph as follows:

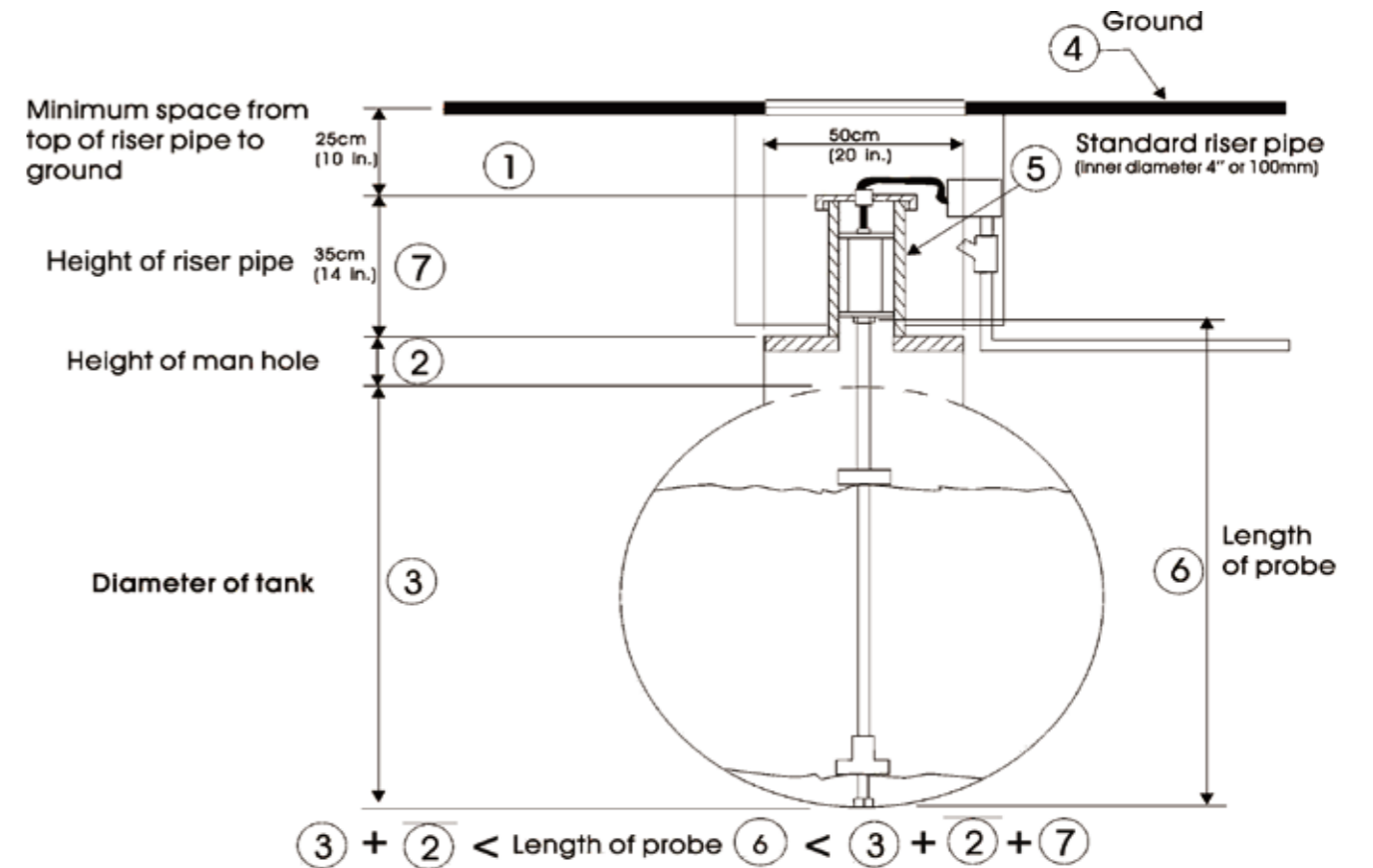

Please note that the riser pipe height should be more than 350mm, if less please tells us for exactly probe length.

Standard SP300 Probe model	Length (mm)	Length (inch)
SP300-1000	1000	39.37
SP300-1350	1350	53
SP300-1750	1750	69
SP300-1960	1960	77
SP300-2260	2260	89
SP300-2570	2570	101
SP300-2670	2670	105
SP300-2870	2870	113
SP300-3170	3170	125

Beijing Sanki Petroleum Technology Co., Ltd.

Add:19#, 6th Boxing Road, Economic-Technological Development Area, Beijing, P.R. China 100176

Tel: 0086-10-52310740 E-mail: business@sankichina.com

# SS160 plus samrt console



SS160Plus offers comprehensive tank monitoring functions including Real-time inventory data, delivery status, alarm conditions and leak-detection information, temperature

## Features:

- International graphic touch screen
- Real time monitoring oil product level, water level, density, volume and temperature
- Monitor up to 12 tank at one compact unit (standard monitor up to 6 tanks)
- Automatic alarm and release alarm
- Automatic generate delivery and leak detection report.
- Automatically generate tank volume chart
- Support TCP/IP
- Support programmable leak detection test PLD
- Support external GSM message module(option)
- Support import & export tank volume chart
- Security password for authorization
- Language optional among English(default), Spanish, Portuguese
- Support connect to Submersible Pump Console SS160-EM02
- Open communication protocol, can be connected with the central control system of mainstream fuel dispensers, totally satisfy management demand of oil retail companies.

## Technical parameters:

- Power: AC220V, 0.2A, 50/60HZ
- Working temperature:-20 C ~+60 C
- Install location: Safety place
- Display resolution: 800x600
- Display size:8" full color LCD
- 2 RS232 communication serial ports: connects to printer, computer, Modem or GSM module.
- 1 USB port for program upgrade
- 1 RS485 communication serial port: connects to probe
- Replay output: 2 groups, Node capacity AC250V/3A, DC30V/3A
- Safety barrier: WB GSB03
- Explosion proof grade:[Ex ia Ga]IIA
- Dimension: 5.7x11.8x9.0 Inches; 145x300x230mm
- Weight:11 Kg.

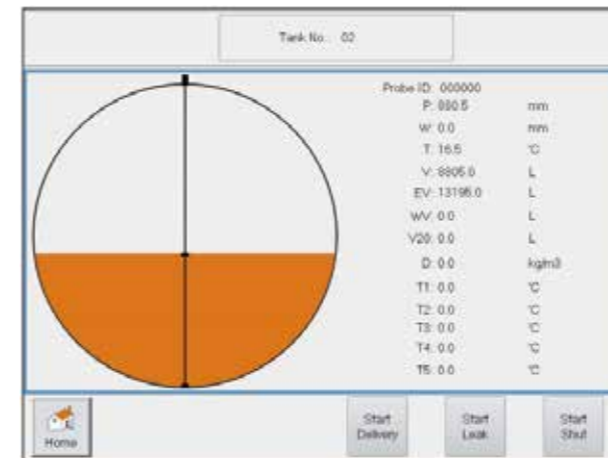

Oil Code	Oil Name	Rate
1 1000	05#	0.0009
2 1001	-00#	0.0009
3 1002	-20#	0.0009
4 1003	-10#	0.0009
5 1004	0#	0.0009
6 1005	90#	0.0012
7 1006	91#	0.0012
8 1007	93#	0.0012
9 1008	95#	0.0012
10 1009	97#	0.0012
11 1010	98#	0.0012
12 1011	-6	0.0012

Tank No	Height	Volume
1 1	0	0
2 1	10	8.7
3 1	20	24.7
4 1	30	45.2
5 1	40	69.4
6 1	50	96.7
7 1	60	126.8
8 1	70	159.4
9 1	80	194.3
10 1	90	231.2
11 1	100	270.1

Beijing Sanki Petroleum Technology Co., Ltd.

Add:19#, 6th Boxing Road, Economic-Technological Development Area, Beijing, P.R. China 100176

Tel: 0086-10-52310740

E-mail: business@sankichina.com

# Fuel Management System

For chain gas station management of oil company

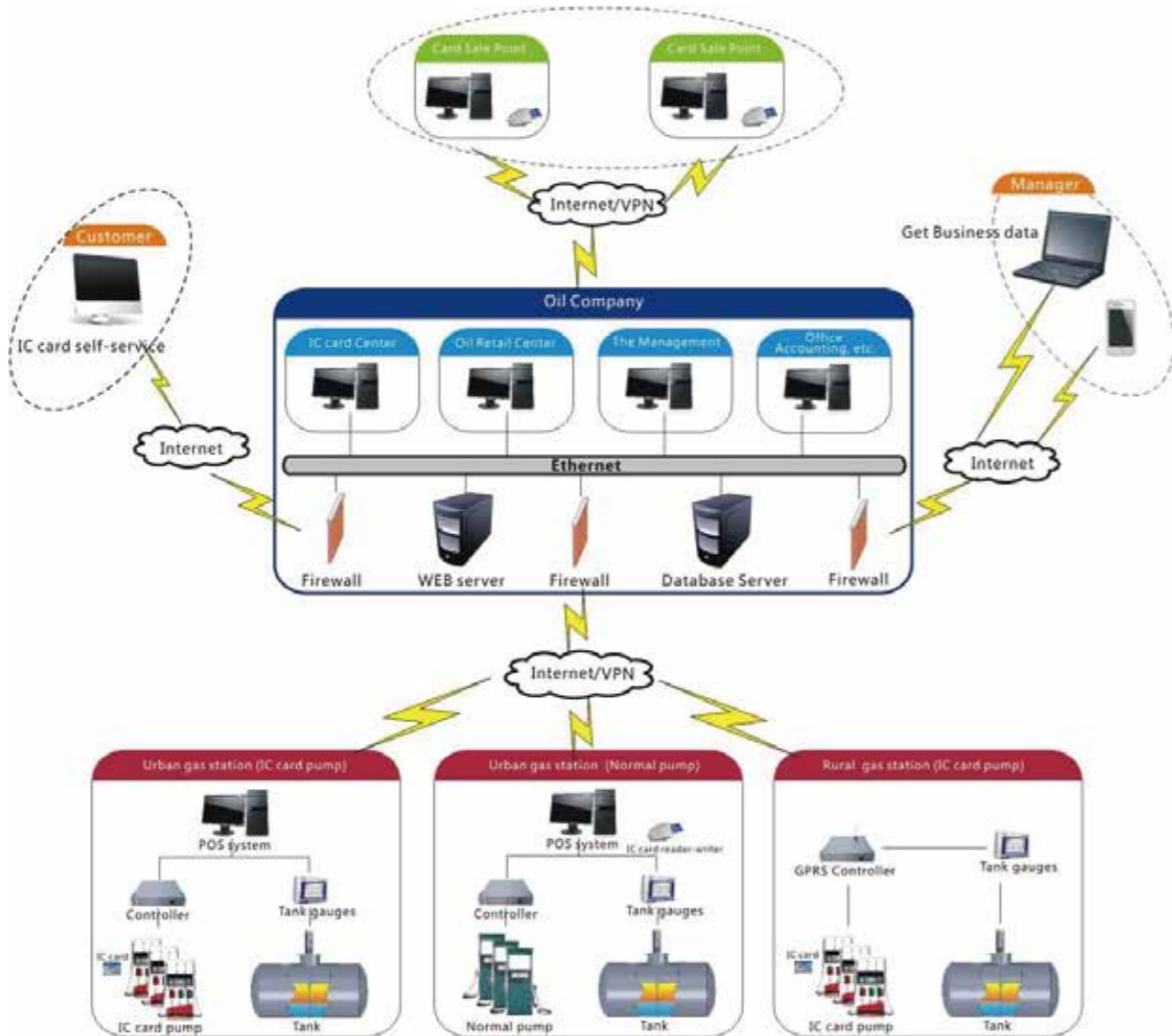

## Features:

- We use CPU card which meet the financial security requirements as IC card.
- The system can connect with many brands IC card dispensers and tank gauges.
- Without computer, the dispenser can store 2000 refueling deals. So, even though the computer's connection is failure, dispensers will work normally.
- The system can manage 100,000 gas stations in a network .
- The system can manage 100,000 deposit points in a network.
- The system can manage 100 million cards.
- You can use the system without geographical restrictions.

## Subsystem Introduction

Subsystem	Function list
<b>IC card gas station management system YS9511</b>	<ul style="list-style-type: none"> <li>• Pump &amp; Tank real-time status monitoring, tank alarm</li> <li>• Fueling transaction real-time reception and display</li> <li>• Real-time total sales accounting for current shift</li> <li>• Price adjustment</li> <li>• Tank delivery registration</li> <li>• Shift processing</li> <li>• Shift inquiry</li> <li>• Sales details inquiry</li> <li>• Operator sales statistics inquiry</li> <li>• Delivery record inquiry</li> <li>• Price changing record inquiry</li> <li>• Pump totalizer inquiry</li> <li>• Oiler workload inquiry</li> <li>• Shift report/Daily report inquiry</li> <li>• Exporting Excel document</li> <li>• Internal card management</li> <li>• Data Transmission</li> </ul>
<b>IC card center management system YS8591</b> <b>IC card sale point system YS8592</b>	<ul style="list-style-type: none"> <li>• User card management</li> <li>• IC Card making</li> <li>• Secret key management</li> <li>• Group customer management</li> <li>• Card daily operation</li> <li>• Reports management</li> <li>• Inquiry &amp; Statistics</li> <li>• System management</li> </ul>
<b>IC card online self-service system YS8597</b>	<ul style="list-style-type: none"> <li>• fueling bills self inquiry</li> <li>• IC card information inquiry</li> <li>• Suspend card online</li> <li>• password self changing</li> </ul>
<b>Retail center management system YS8800</b>	<ul style="list-style-type: none"> <li>• Delivery Management</li> <li>• Sales Management</li> <li>• Inventory Management</li> <li>• Reports Management</li> <li>• Business Analysis</li> <li>• Sales Plan Management</li> <li>• Price Adjustment</li> </ul>

Beijing Sanki Petroleum Technology Co., Ltd.

Add:19#, 6th Boxing Road, Economic-Technological Development Area, Beijing, P.R. China 100176

Tel: 0086-10-52310740 E-mail: business@sankichina.com

# Fuel Management System

## Card solution for single gas station

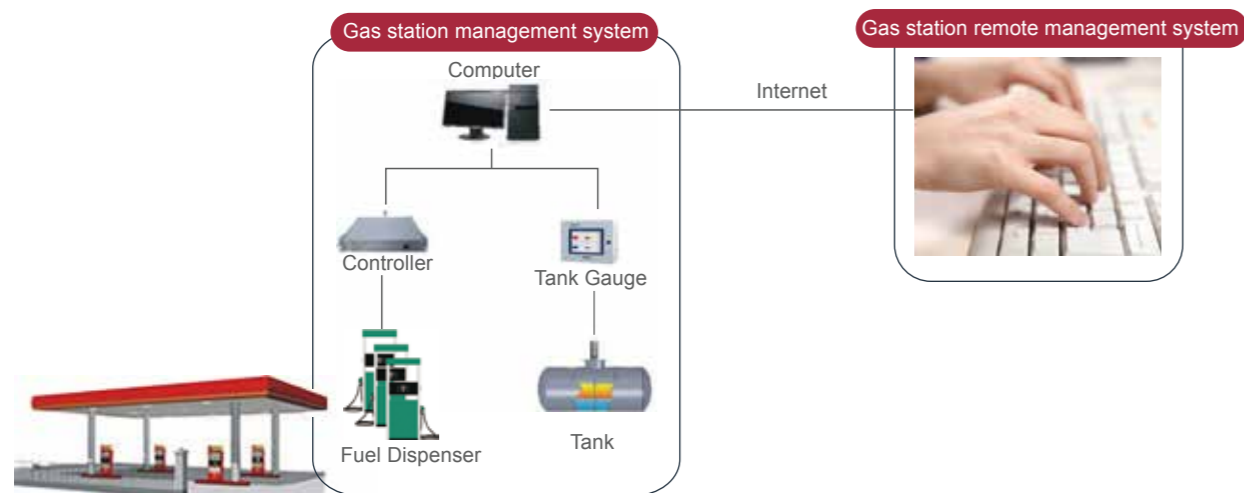

The solution is designed for the single gas station with IC card dispenser, support of the IC card settlement. This solution is comprised of the gas station management system (YS9511/YS9550), IC card management system YS8590, IC card online self-service system (YS8597). It is able to complete the daily oil invoicing management of gas station, IC card customer management, IC cards customer online self-service.

Subsystem Introduction

### Subsystem Introduction

<p><b>IC card gas station management system</b>(YS9511/YS9550)</p> <p><b>Remark:</b> If you have IC card dispenser, please choose YS9511, the customer swipe card by dispenser's IC card reader; If you have ordinary dispenser, please choose YS9510, the customer swipe card by the IC card reader which is connect to the computer.</p>	<ul style="list-style-type: none"> <li>• (dispensers and tank) Status monitoring</li> <li>• Daily operation</li> <li>• Information inquiry</li> <li>• Report management</li> <li>• Data transmission</li> <li>• Keyword management</li> <li>• IC card making</li> <li>• Unit customer management</li> <li>• Card daily operation</li> <li>• Inquiry and statistics of card</li> </ul>
<p><b>IC card management system</b> YS8590</p>	<ul style="list-style-type: none"> <li>• User card management</li> <li>• IC Card making</li> <li>• Secret key management</li> <li>• Group customer management</li> <li>• Card daily operation</li> <li>• Reports management</li> <li>• Inquiry &amp; Statistics</li> <li>• System management</li> </ul>
<p><b>IC card online self-service system</b>(YS8597)</p> <p><b>Remark:</b> It's designed for the IC card customers who can print the bills or</p>	<ul style="list-style-type: none"> <li>• Bills of customer</li> <li>• IC card information inquiry</li> <li>• Suspend IC card online</li> </ul>

# Fuel Management System

## Without card solution for single gas station

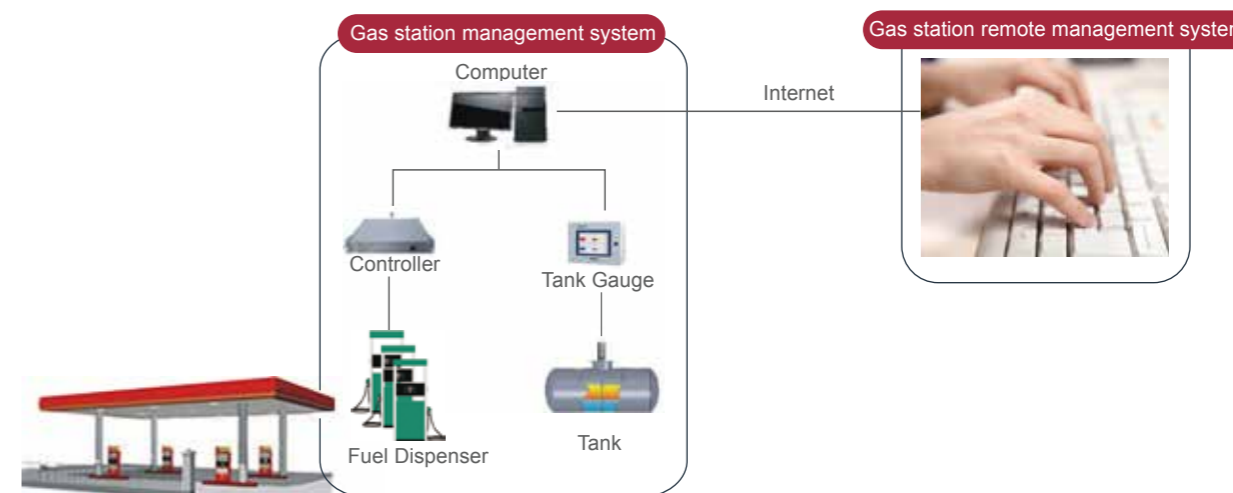

The solution is designed specifically for the single gas station with ordinary dispenser. This solution is comprised of the gas station management system (YS8100/8150) and the gas station remote monitoring system (YS8700). It is able to complete the daily oil invoicing management work, and also support the gas station manager to remotely view the state of operation. It's low-cost, cost-effective.

### Subsystem Introduction

<p><b>Gas station management system</b> (YS8100/8150)</p> <p><b>Remark:</b> The support ability limit of this system: support as many as 9 tanks, 128 nozzles, 8 communication controllers and 1 tank gauge.</p>	<ul style="list-style-type: none"> <li>• (dispensers and tank) Status monitoring</li> <li>• Price adjustment</li> <li>• Delivery registration</li> <li>• Shift processing</li> <li>• Information inquiry</li> <li>• Report management</li> </ul>
<p><b>Gas station remote management system</b> (YS8700)</p> <p><b>Remark:</b> It is designed for the manager or leader of gas station who can inquire operation information anytime anywhere over the network.</p>	<ul style="list-style-type: none"> <li>• Tank status monitoring</li> <li>• Nozzles status monitoring</li> <li>• Shift report inquiry</li> <li>• Daily report inquiry</li> <li>• Inventory inquiry</li> <li>• Price adjustment inquiry</li> <li>• Delivery inquiry</li> <li>• Change password</li> </ul>

Beijing Sanki Petroleum Technology Co., Ltd.

Add:19#, 6th Boxing Road, Economic-Technological Development Area, Beijing, P.R. China 100176

Tel: 0086-10-52310740 E-mail: business@sankichina.com



# Tank Calibration System

SANKI tank calibration system is manufactured in fully accordance with JJG266-1996, JJG133-2005 and other national measurement regulations, thus sufficiently guaranteeing the accuracy.

## Main technical parameters :

Measured height	3800mm at maximum	Differentiate ratio	0.02mm
Accuracy	±0.5mm	Measure accuracy	<±0.5%
Measuring range	(80~250)L/min	Power supply	AC 380V 50Hz
Ambient temperature	-25 C - +55 C	Relative humidity	20%~95%RH
Working pressure	≤0.5MPa	Apply to	Diesel
Ex-proof mark	Exdmb II AT3		

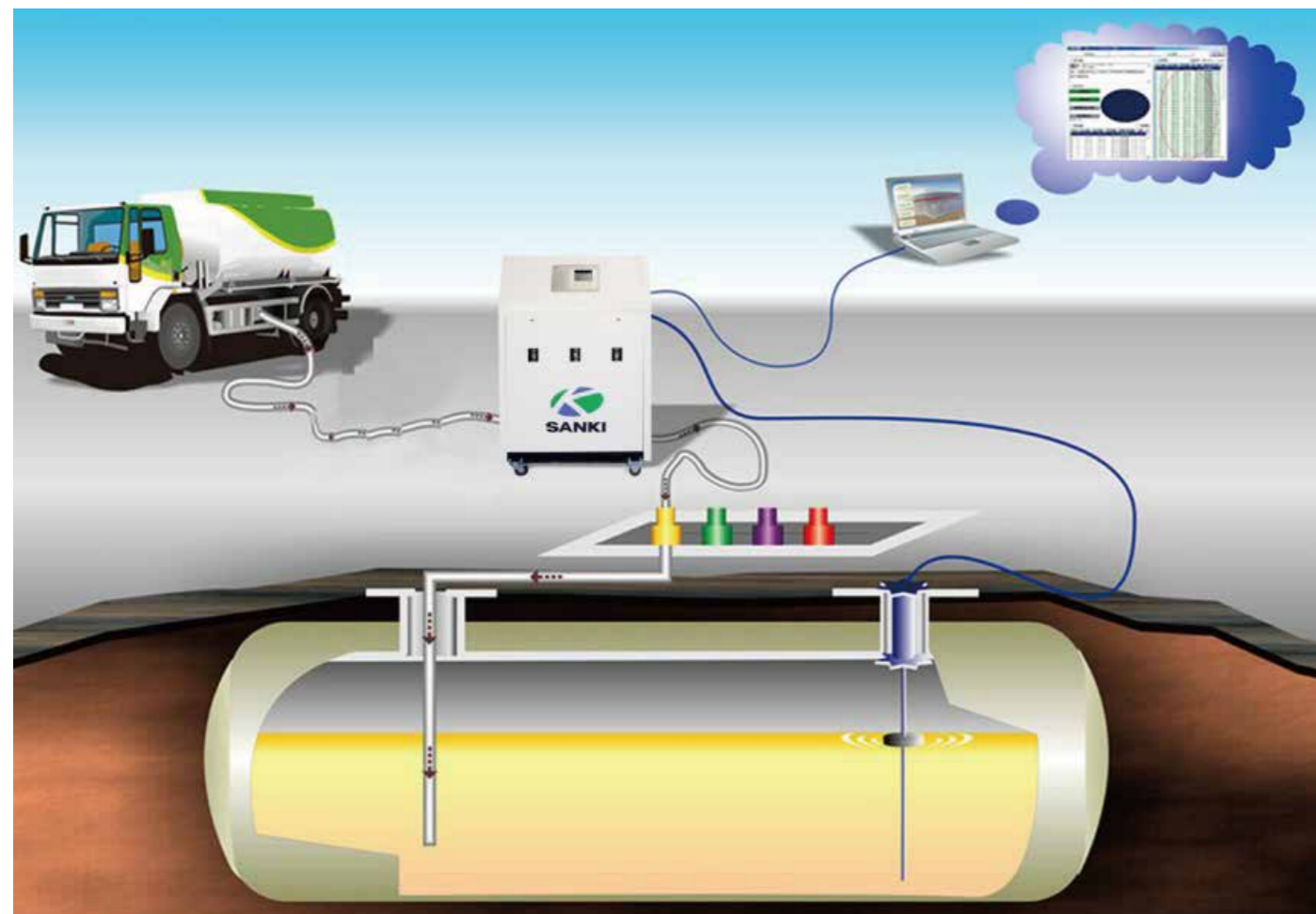

Schematic of Calibration System

Discharge the oil to the measured tank through volume measurement machine, which accurately measure the oil volume unloaded, then probe detect the oil level inside the tank, and the computer collect real-time data from both parties, the computer will automatically generate volume chart.

## Features:

- Automatically generate volume chart, without manual operation.
- High accurate volume chart produced, error less than 0.5%.
- Fast measure speed, less than 2 hours if calibrating a tank 30CBM.
- Oil discharging or sucking, both ways to create volume chart.
- Interval stop or non stop working ways.
- Automatic measurement or manual data input, two ways for chart.
- High oil level limitation setting automatically to avoid overflow.
- Powerful data save mechanism, avoid data loss.
- Multi-scale volume chart available for creation.
- Data copy available to avoid loss.
- Volume chart data available imported to Word, Excel and Txt format.
- Chinese and English language for choice.

## Main System Components



Volumetric Measurement Machine



Magnetostrictive Probe



Laptop



USB to RS232 serial port line



Power supply socket and line



Communication socket and line



Inlet & Outlet oil pipeline



Measuring hose and nozzle



Ground clamp



Dipstick

Beijing Sanki Petroleum Technology Co., Ltd.

Add:19#, 6th Boxing Road, Economic-Technological Development Area, Beijing, P.R. China 100176

Tel: 0086-10-52310740 E-mail: business@sankichina.com

# Mechanical spare parts



**GP-50 Gear Pump**

- Flow rate:  $\geq 40\text{L/min}$
- Suction:  $\leq 5\text{m}$
- Working life:  $> 10,000,000\text{L}$
- Inlet vacuum:  $\geq 54\text{kPa}$
- Adjusting pressure:  $0.18\text{ Mpa} \sim 0.20\text{Mpa}$
- Outlet pressure:  $\leq 0.3\text{Mpa}$
- Noise:  $\leq 68\text{dB}$
- Ambient temperature:  $-25^{\circ}\text{C} \sim 55^{\circ}\text{C}$



**SANKI Gear Pump**

- Flow rate:  $\geq 40\text{L/min}$
- Suction:  $\leq 5\text{m}$
- Working life:  $> 10,000,000\text{L}$
- Inlet vacuum:  $\geq 54\text{kPa}$
- Adjusting pressure:  $0.10\text{Mpa} \sim 0.22\text{Mpa}$
- Outlet pressure:  $\leq 0.3\text{Mpa}$
- Noise:  $\leq 68\text{dB}$
- Ambient temperature:  $-25^{\circ}\text{C} \sim 55^{\circ}\text{C}$



**Vane Pump**

- Flow rate:  $\geq 40\text{L/min}$
- Suction:  $\leq 4\text{m}$
- Working life:  $> 3,000,000\text{L}$
- Inlet vacuum:  $\geq 54\text{kPa}$
- Adjusting pressure:  $0.14\text{Mpa} \sim 0.20\text{Mpa}$
- Outlet pressure:  $\leq 0.3\text{Mpa}$
- Noise:  $\leq 68\text{dB}$
- Ambient temperature:  $-25^{\circ}\text{C} \sim 55^{\circ}\text{C}$

## Flow meter



**FM-500 flow meter**



**SANKI flow meter**

### Technical specification :

- Volume/cycle: 0.5L
- Working pressure:  $\leq 0.30\text{MPa}$
- Flow range: 5-50L/Min for standard duty  
70 L/Min for heavy duty
- Accuracy: maximum allowed error  $\leq \pm 0.20\%$   
repetitive error  $\leq 0.10\%$
- Adjusted range: 1%
- Working life: 10,000,000L
- Ambient humidity: 20%~95%

## Motor



Model	Power	Voltage	Current	Frequency	Full Load R.P.M	Weight (KG)	Ex-Proof certification
YBSL-8024	750W	380V	2.0A	50Hz	1390r/min	16	CNEX
YBSL-8034	1000W	380V	2.6A	60Hz	1390r/min	16	CNEX



Model	Power	Voltage	Current	Frequency	Full Load R.P.M	Weight (KG)	Ex-Proof certification
YBB3441E	750W	220V	5.0A	50Hz	1440r/min	18	ATEX, UL
YBB3441EC	1000W	230V	6.45A	60Hz	1730r/min	18	CNEX



Model	Power	Voltage	Current	Frequency	Full Load R.P.M	Weight (KG)	Ex-Proof certification
IEExHA08-53-4	750W	240V	5.0A	50Hz	1450r/min	16	IECEX, ATEX
IEExHA08-53-4(H)	1000W	240V	6.45A	60Hz	1750r/min	16	IECEX, ATEX

Beijing Sanki Petroleum Technology Co., Ltd.

Add:19#, 6th Boxing Road, Economic-Technological Development Area, Beijing, P.R. China 100176

Tel: 0086-10-52310740 E-mail: business@sankichina.com

# Electronic spare parts

## Main board



- Based on the powerful single-chip ARM7TDMI-S, the 32 bit central processing unit, which posses 512KB internal flash ROM,32KB static SRAM, ISP, IAP function. and it expands another 64KB SRAM.
- The high quality measurement;
- Integrated Electronic Calibration of meters(EC);
- Support display digit expansion;(Sale:7digit, Litre:6digit, Price:5digit)
- Expanded interfaces(support and connect printer, IC card, ID card, vapor recovery system, site system with RS85/CURRENT LOOP standard, etc);
- 3 level software operating interfaces, different password is necessary for different safety grade to get through level interfaces.
- High reliability and performance, its low price and its guaranteed quality.

## Control board



- Switch weak signal to strong voltage signal to turn on/off motor and solenoid valve.
- Transmit commands to the calculator from nozzle switch, sensor;
- Transfer command from the calculator to electromagnetic counter;
- Transfer inlet power supply to power filter;

## Pulser



Working Voltage	DC 12V
Working Current	≤30mA
Ambient Temperature	-25℃ ~ +55℃
Output Pulse characteristics	Output duplex pulse signa, Output OD
Type of Output Pulse	A、B pulse is 90° phase, 50 Pulse/R

## Solenoid Valve



Suitable media	Petrol, diesel, kerosene
Ambient temperature	-40℃ ~ +55℃
Media temperature	-40℃ ~ +55℃
Working pressure	0.035MPa ~ 0.35 MPa
Explosion-proof mark	Ex m II T3
Suitable voltage	220VAC 50/60Hz; 110 VAC 50/60Hz; DC12V; DC24V etc
Voltage deviation	-10%~+15%
Insulation strength	≥20MΩ
Power	2×5.5W
Flow	≥40L/min(High flow); 3-5L/min(Low flow)

## Junction Box



Item	Parameter
Working voltage	380V AC /220V AC、 12V DC
Working current	10A
Anti-explosion sign	Exd II AT3 Gb
Number of cables connected to devices	5
Minimum outer diameter of cable	φ7、 φ10
Appearance dimensions	145mm×150mm×92mm
Explosion-proof grade	IP44

Beijing Sanki Petroleum Technology Co., Ltd.

Add:19#, 6th Boxing Road, Economic-Technological Development Area, Beijing, P.R. China 100176

Tel: 0086-10-52310740 E-mail: business@sankichina.com

# SK15 series fuel dispenser

## Features:

- **Economic Pump/dispenser ranges :**  
1-2 hose, customized design for different customer and different demands  
Optional for pump and dispenser, available for gasoline and diesel
- **Highly trustable and accurate SANKI flow meter**  
4 piston design, inlet up and out down design to ensure clean of flow meter  
Reduce fuel loss by highly stable and accurate flow meter
- **Build to harshest environment**  
Frame and panel is material with cold plated steel, with very strong construction  
Electronic designed to fit for ultra high and ultra low environment -40 C ~ +50 C  
Motor is designed with wide range of voltage working
- **Easy for maintenance**  
Global accessible spare parts for maintenance  
Modular designed electronic and hydraulic easy to replace parts



ISO 9001



OIML



CNEX



ISO14001



PEI

## ● Technical parameters :

Accuracy for the unit	±0.25%
Standard flow rate	45L/min
Ambient temperature	-25 C ~ +55 C ; -40 C ~ +50 C
Relative humidity	20% - 95%
Unit noise rate	< 70dB (A);
Inlet vacuum rate for suction pump	≥54kPa
Communication	With RS 485 port, or current loop
Power supply	AC 220V( -15%~+10%); (50/60±1)Hz ; AC 380V( -15%~+10%); (50/60±1)Hz
Digit of sale	7digits (Decimal points can be adjusted)
Digit of volume	6digits (Decimal points can be adjusted)
Digit of unit price	5digits (Decimal points can be adjusted)
Totalizer of sale	0~42949672.95
Totalizer of volume	0~42949672.95

## ● Optional configuration :

Printer , ID card , communication for FMS , break away, swivel, emergency stop, LED light, etc.

## ● Model Range :

Model	Pump Unit	Nozzle	Product	Display	Packing Size(mm)	Gross Weight(Kg)
SK15ZF111B	Suction pump	1	1	2	1080*490*2188	145
SK15ZF212B		2	1	4	1080*490*2188	160
SK15ZF222B		2	2	4	1080*490*2188	186

Beijing Sanki Petroleum Technology Co., Ltd.

Add:19#, 6th Boxing Road, Economic-Technological Development Area, Beijing, P.R. China 100176

Tel: 0086-10-52310740 E-mail: business@sankichina.com

# SK52 series fuel dispenser



## Features:

- Flexible Pump/dispenser ranges**  
 1-2 hose, wide range of configuration  
 Optional for pump and dispenser, 45 to 80 lpm.  
 Customized design for different customer and different demands  
 Available for gasoline and diesel
- Highly trustable and accurate SANKI flow meter**  
 4 piston design, inlet up and out down design to ensure clean of flow meter  
 Reduce fuel loss by highly stable and accurate flow meter
- Build to harshest environment**  
 Frame and panel is material with cold plated steel, with very strong construction  
 Electronic designed to fit for ultra high and ultra low environment -40°C ~ +50°C  
 Motor is designed with wide range of voltage working
- Easy for maintenance**  
 Global accessible spare parts for maintenance  
 Modular designed electronic and hydraulic easy to replace parts



ISO 9001



OIML



CNEX



ISO 14001



PEI

## Technical parameters :

Accuracy for the unit	±0.25%
Flow rate	45~80L/min
Ambient temperature	-25°C ~ +55°C ; -40°C ~ +50°C
Relative humidity	20% - 95%
Unit noise rate	< 70dB (A);
Inlet vacuum rate for suction pump	≥54kPa
Communication	With RS 485 port, or current loop
Power supply	AC 220V( -15%~+10%);(50/60±1)Hz ; AC 380V( -15%~+10%);(50/60±1)Hz
Digit of sale	7digits (Decimal points can be adjusted )
Digit of volume	6digits (Decimal points can be adjusted )
Digit of unit price	5digits (Decimal points can be adjusted )
Totalizer of sale	0~42949672.95
Totalizer of volume	0~42949672.95

## Optional configuration :

Printer, IC card, ID card, communication for FMS, vapor recovery, break away, swivel, emergency stop, LED light, etc.

## Model Range :

Model	Pump Unit	Nozzle	Product	Flow Rate	Display	Package Size(mm)	Gross Weight(Kg)
SK52Z/GF111B	Suction pump	1	1	45/60/80	2	1080*490*2188	230/245
SK52Z/GF212B		2	1	45/60/80	2	1080*490*2188	265/280
SK52Z/GF222B		2	2	45/60/80	2	1080*490*2188	293/308
SK52QF111B	Submersible pump	1	1	45/60/80	2	1080*490*2188	200
SK52QF212B		2	1	45/60/80	2	1080*490*2188	223
SK52QF222B		2	2	45/60/80	2	1080*490*2188	230

Beijing Sanki Petroleum Technology Co., Ltd.

Add:19#, 6th Boxing Road, Economic-Technological Development Area, Beijing, P.R. China 100176

Tel: 0086-10-52310740 E-mail: business@sankichina.com

# SK56 series fuel dispenser

## Features:

- Alternative fuel supply to increase customer loyalty**  
 4-8 hose, come in a range of fuel option  
 Optional for pump and dispenser, available for gasoline and diesel
- Highly trustable and accurate SANKI flow meter**  
 4 piston design, inlet up and out down design to ensure clean of flow meter  
 Reduce fuel loss by highly stable and accurate flow meter
- Build to harshest environment**  
 with very strong construction with good material  
 Electronic designed to fit for ultra high and ultra low environment -40°C~50°C  
 Motor is designed with wide range of voltage working
- Easy for maintenance**  
 Global accessible spare parts for maintenance  
 Modular designed electronic and hydraulic easy to replace parts



ISO 9001



OIML



CNEX



ISO14001



PEI

## Technical parameters :

Accuracy for the unit	±0.25%
Standard flow rate	45L/min
Ambient temperature	-25℃~ +55℃; -40℃~ +50℃
Relative humidity	20% - 95%
Unit noise rate	< 70dB (A);
Inlet vacuum rate for suction pump	≥54kPa
Communication	With RS 485 port, or current loop
Power supply	AC 220V( -15%~+10%); (50/60±1)Hz;
Digit of sale	AC 380V( -15%~+10%); (50/60±1)Hz
Digit of volume	7digits (decimal points can be adjusted)
Digit of unit price	6digits (Decimal points can be adjusted)
Totalizer of sale	5digits (Decimal points can be adjusted)
Totalizer of volume	0~42949672.95

## Optional configuration :

Printer, IC card, ID card, communication for FMS, vapor recovery, break away, swivel, emergency stop, etc.

## Model Range :

Model	Pump Unit	Nozzle	Product	Display	Package Size(mm)	Gross Weight(Kg)
SK56GF422B	Suction pump	4	2	2	1318*820*2480	397
SK56GF424B		4	2	4	1318*820*2480	397
SK56GF636B		6	3	6	1318*820*2480	427
SK56GF632B		6	3	2	1318*820*2480	427
SK56GF634B		6	3	4	1318*820*2480	427
SK56GF842B		8	4	2	1360*820*2480	600
SK56QF422B	Submersible pump	4	2	2	1318*820*2480	315
SK56QF424B		4	2	4	1318*820*2480	315
SK56QF636B		6	3	6	1318*820*2480	349
SK56QF632B		6	3	2	1318*820*2480	349
SK56QF634B		6	3	4	1318*820*2480	349
SK56QF842B		8	4	2	1360*820*2480	383

Beijing Sanki Petroleum Technology Co., Ltd.

Add:19#, 6th Boxing Road, Economic-Technological Development Area, Beijing, P.R. China 100176

Tel: 0086-10-52310740

E-mail: business@sankichina.com

# AdBlue



With integrated design, the dispenser and AdBlue containerized tank are integrated into a skid, which is convenient for transportation and installation.

Configuring with hose reel, the hose can stretch out and draw back automatically, maximum extension can reach 10 meters.

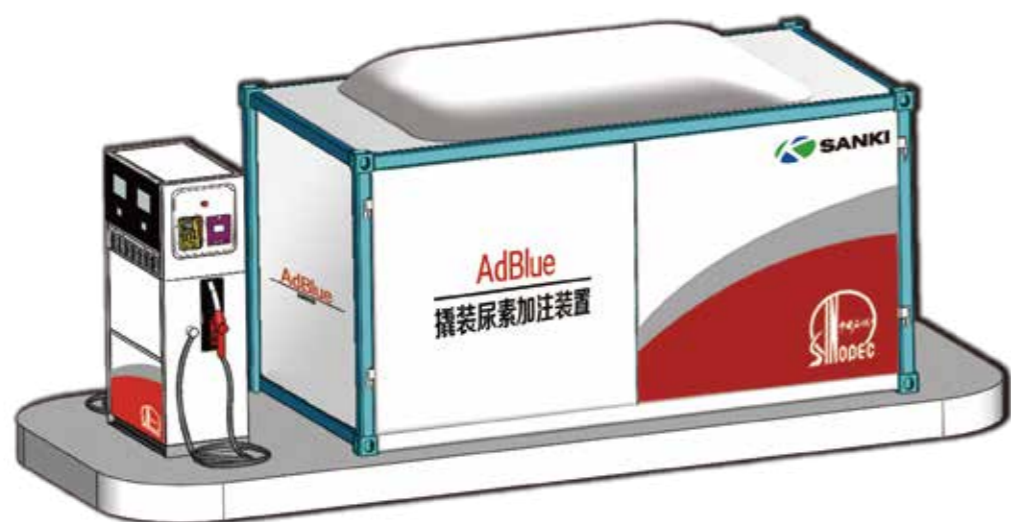

Designed in modularization. The AdBlue dispenser and pry are independent unit, Installation position can be set according to the conditions.

The AdBlue dispenser has two type: 1 nozzle and 2 nozzles

## Containerized tank capacity:

Containerized tank capacity includes 2000L, 3000L and 5000L etc, also can be made according to customer's demand.

**Divided AdBlue dispenser dimension:** 800X460X1450 (mm)

## Features:

- Integrated design, site selection is flexible, convenient for installation
- With quantitative filling, non-quantitative filling, auto off, automatic settlement and other function
- Can be connected to FMS, with barcode scanning, voice self-service, multimedia, and other functions
- With low level alarm function;
- High quality. Using special components with strong resistance to AdBlue, all pipe joints are stainless steel, will not cause pollution to the AdBlue liquid.
- Low cost and economic. The containerized tank is equipped with rapid assembling device, it is easy for replace AdBlue tons of barrels (1 cube) which can be used recyclable.
- Insulation layer in the containerized tank can ensure the AdBlue storage environment; the tank equipped with dispenser which has air conditioner can adapt to the harsh low and high temperature.

## Main technical parameters of the AdBlue dispenser:

Flow rate range	5 ~ 35L/min
Acuracy	≤ ±0.30%
Working pressure	<0.3MPa
Power supply	three phase 380V 50HZ ; single phase 220V 50HZ
Single counting range	0 ~ 9999.99
Sale	0 ~ 9999.99
Totalize of volume	0 ~ 9999999.99
Totalize of sale	0 ~ 99999999.99
Unit price range	0.01 ~ 99.99
Ambient temperature	-10 ~ +45° C (air-conditioning thermostatic system is needed if the Ambient temperature is less than -15 ° C, and can only use all-in-one type)

## Main components parameters

- a) AdBlue pump: 220V/370W AC 50Hz      b) AdBlue flow meter: 35-45L/min  
c) Stainless steel self sealing nozzle :3/4"      d) AdBlue solenoid valve: 3/4", 12V/24V

Beijing Sanki Petroleum Technology Co., Ltd.

Add:19#, 6th Boxing Road, Economic-Technological Development Area, Beijing, P.R. China 100176

Tel: 0086-10-52310740      E-mail: business@sankichina.com